

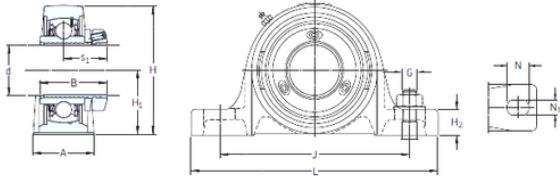

# BEARING-SINGAPORE (PTE)LTD.



## SKF SY 2.15/16 PF/AH bearing units

Bearing No. SY 2.15/16 PF/AH

SY 2.15/16 PF/AH Bearing 2D drawings and 3D CAD models

Bore Diameter	74,6125 mm
Width	63,5 mm
d	74,6125 mm
s1	39,8 mm
A	71,6 mm
B	63,5 mm
G	20 mm
H	166,1 mm
H1	82,5 mm
H2	32,8 mm
J	216 mm
L	279 mm
N	35 mm
N1	22,2 mm
Weight	7,25 Kg
Basic dynamic load rating (C)	66,3 kN
Basic static load rating (C0)	49 kN
Category	Pillow Block Bearings
Inventory	0.0
Manufacturer Name	SKF
Minimum Buy Quantity	N/A
Weight / Kilogram	7.26
EAN	7316572045510
Product Group	M06110
Number of Mounting Holes	2
Mounting Method	Stepped Sleeve



## BEARING-SINGAPORE (PTE)LTD.

Housing Style	2 Bolt Pillow Block
Rolling Element	Ball Bearing
Housing Material	Cast Iron
Expansion / Non-expansion	Non-expansion
Mounting Bolts	3/4 Inch
Relubricatable	Yes
Insert Part Number	YSP 215-215-2F/AH
Seals	M Seal
Housing Configuration	1 Piece Solid
Inch - Metric	Inch
Other Features	Single Row   Standard Duty   Wide Inner Race   Air Handling   Anti Rotation Pin   Has Flinger   Y Bearing   With Grub Screw
Long Description	2 Bolt Pillow Block; 2-15/16" Bore; 3-1/4" Base to Center Height; Stepped Sleeve Mount; Ball Bearing; 8" Minimum Bolt Spacing; 9" Bolt Spacing Maximum; Relubricatable; Cast Iron; M
Category	Pillow Block
UNSPSC	31171511
Harmonized Tariff Code	8483.20.40.40
Noun	Bearing
Keyword String	Pillow Block
Manufacturer URL	<a href="http://www.skf.com">http://www.skf.com</a>
Manufacturer Item Number	SY 2.15/16 PF/AH
Weight / LBS	16
Base to Center Height	3.25 Inch   82.55 Millimeter
Actual Bolt Center to Center	0 Inch   0Millimeter
Nominal Bolt Center to Center	8.5 Inch   215.5 Millimeter
Length Thru Bore	2.5 Inch   63.5 Millimeter



## BEARING-SINGAPORE (PTE)LTD.

Bolt Spacing Maximum	9 Inch   228.6Millimeter
Bore	2.938 Inch   74.625 Millimeter
Bolt Spacing Minimum	8 Inch   203.2Millimeter