

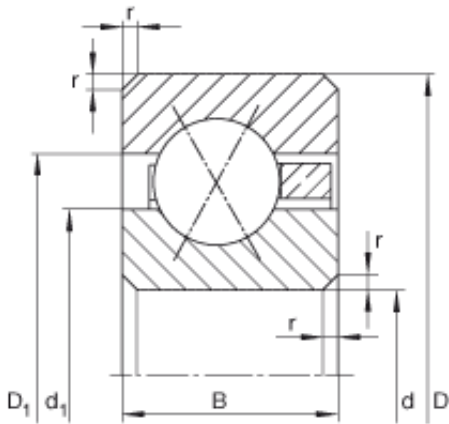

BEARING-SINGAPORE (PTE)LTD.

11 inch x 317,5 mm x 19,05 mm INA CSXF110
deep groove ball bearings

Bearing No. CSXF110



CSXF110 Bearing 2D drawings and 3D CAD models

Size	279.4x317.5x19.05 mm
Bore Diameter	279,4 mm
Outer Diameter	317,5 mm
Width	19,05 mm
d	279,4 mm
d	11 inch
D	317,5 mm
B	19,05 mm
D ₁	303,4 mm
d ₁	293,5 mm
r _{min}	2 mm
m	2,18 kg / Weight
C _r	44500 N / Dynamic load rating (radial)
C _{0r}	92000 N / Static load rating (radial)